

## USAGE INSTRUCTIONS

### moppitt® Cleaning PODS, with Extenda- Pole™ and Hand-Held

To use moppitt®, attach PODS that have been pre-moistened with interior cleaning liquid to the extendable pole to clean bathrooms, floors, sinks, windows and other hard surfaces.



#### **USING moppitt® EXTENDA-POLE:**

1. Remove pole and POD from moppitt® bag stored in a small closet or overhead bin.
2. Extend the pole handle by releasing the clamp.
3. Puncture POD lid to open and attach cleaning pad. Pull pad out and discard cup.
4. Press down onto the surface to be cleaned and mop with even back and forth mopping strokes to cover a 5-foot by 5-foot area. Repeat mopping until the surface is visibly wet. Allow the area to dry without further mopping.
5. Eject soiled pad by collapsing pole handle and pad will be pushed off the end.

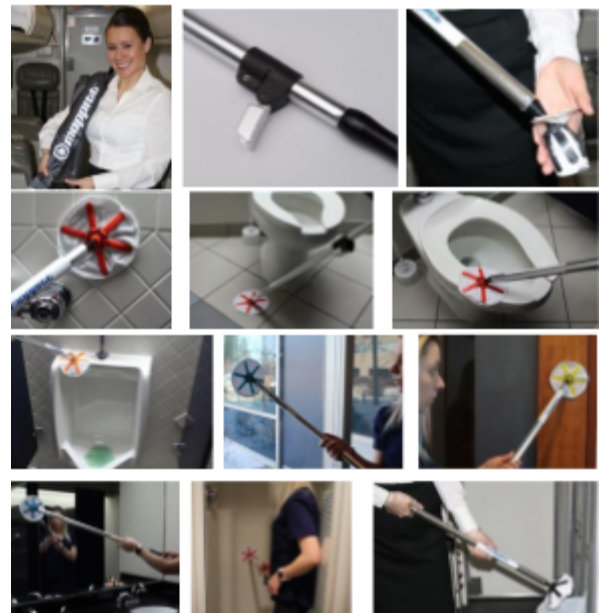

#### **USING moppitt® HAND-HELD:**

1. Remove a Hand-Held from storage bag.
2. Puncture POD lid to open and attach cleaning pad.
3. Clean surfaces.
4. Eject soiled pad by pushing the grey button.



#### **COLOR CODING:**

- BLUE** – GLASS - AZURE
- RED** – BATHROOM - QUAT
- ORANGE** – URINAL – BIO-BAC
- GREEN** – GENERAL CLEANER - EMERALD
- YELLOW** – NEUTRAL FLOOR CLEANER – EXCELISOIR
- BLACK** – DRY DUSTER

